

Double Macrame Bracelet with Button



by
Sandra Younger
for
 TierraCast

Supplies

Tierra cast Button
Closed ring 6mm to 8mm
Beads with 1mm hole
Waxed Braided cord #12
Faux leather 1mm

Optional

leaded needle

Tools

scissors
lighter or thread burner
The Knotty Do-It-All knotting
and design board

Tips and Tricks

When you macrame, you want to make sure there isn't a lot of extra space inside your beads after you have strung your beads on. One way to do this is to double your cord and use a leaded needle to string your beads on. The most important thing is to not force the beads on since this could cause your them to crack. I like doubling my cord for a variety of techniques, such as knotting and braiding, so having them handy is very helpful. I make mine extra long so that I can reuse them. When you make yours, just sting the fishing line on, but do not knot it until you are ready to use it. This keeps them from getting tangled. I store mine on a magnet.

Melting your cord with a lighter is fine, just be careful and keep lighters away from children. Aside from lighters I like using thread burners. If you are an avid jewelry maker and melt thread often I suggest getting a dental cauterizer.

THIS IS ONE I HAVE AND USE EVERYDAY

This kit is great because it has a high-melt for thick thread and a low-melt for thinner threads, such as S-lon. I recommend using rechargeable batteries since they drain regular batteries very quickly.

Double Macrame Bracelet with Button

I am using:

Waxed Braided Cord size 12,
two separate strands:

Strand 1-2 yards, fold in half, add **leadered needle** (see next page), string on beads, cut off leadered needle and attach button with larks head knot at fold of cord.

Strand 2- 1.5 yards, feed through larks head knot, center cord and begin macrame.

See photos 1, 2, and 3.

10" of Faux Leather size 1mm for button loop



1
After I have strung on my beads and trimmed off the leadered needle I attach the button to the folded end using a larks head knot.

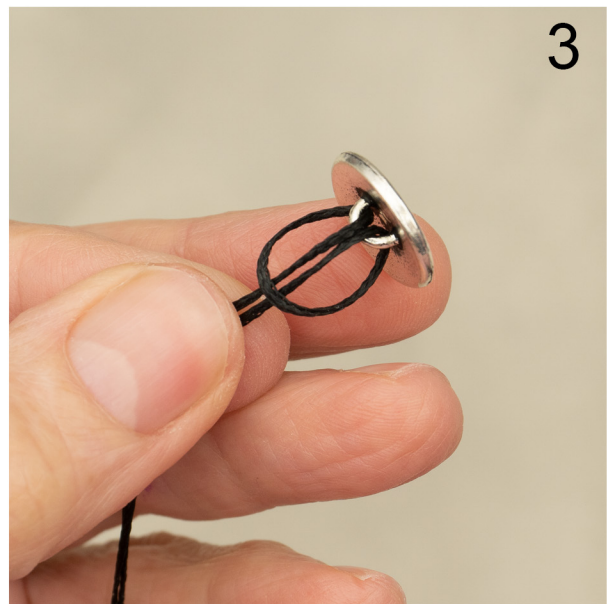

Feed 1.5 yards of cord through lark's head and center the strings so that half is to the right and half to the left.

This bracelet has a chunky look and is achieved by macraming over a macrame. We will make our first pass with four macrame knots in between beads, attach the closed ring and macrame the second pass that will produce the chunky look.

We will also make a sliding button closure which is GREAT if your button is on the larger side.

Here is a link to the video that will demonstrate how to do this!

What is a leadered needle?

A leadered needle is a thin needle threaded with fishing line.



The fishing line is knotted at the end to form a closed loop and offset to the side.

Cord, silk thread for example, is fed through the loop creating a doubled cord.

This helps stringing beads on to cords that easily fray, such as silk and nylon, and it makes stringing beads onto any cord much faster.